

GeckoRacing

Ducati Monster 600, 620, 695, 720, 800, 900, 1000, S4

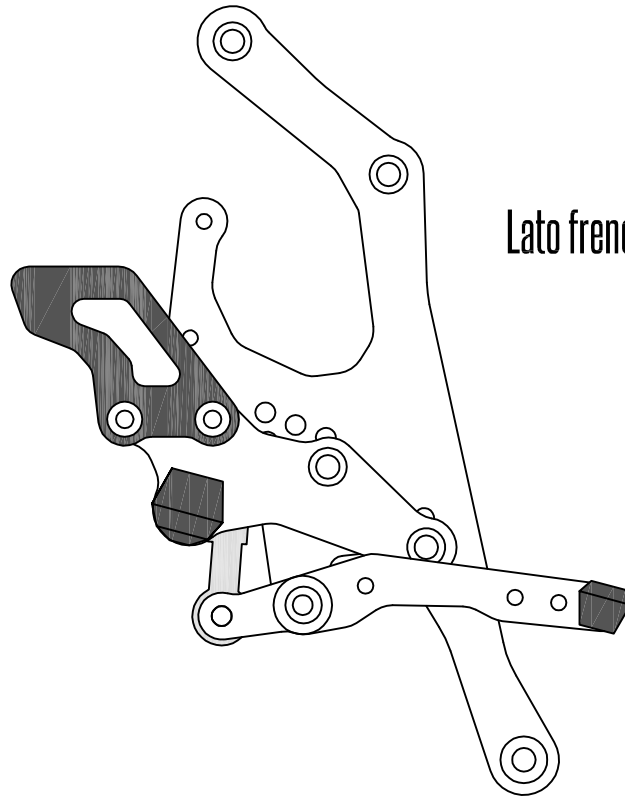

Lato freno - *Brake side*

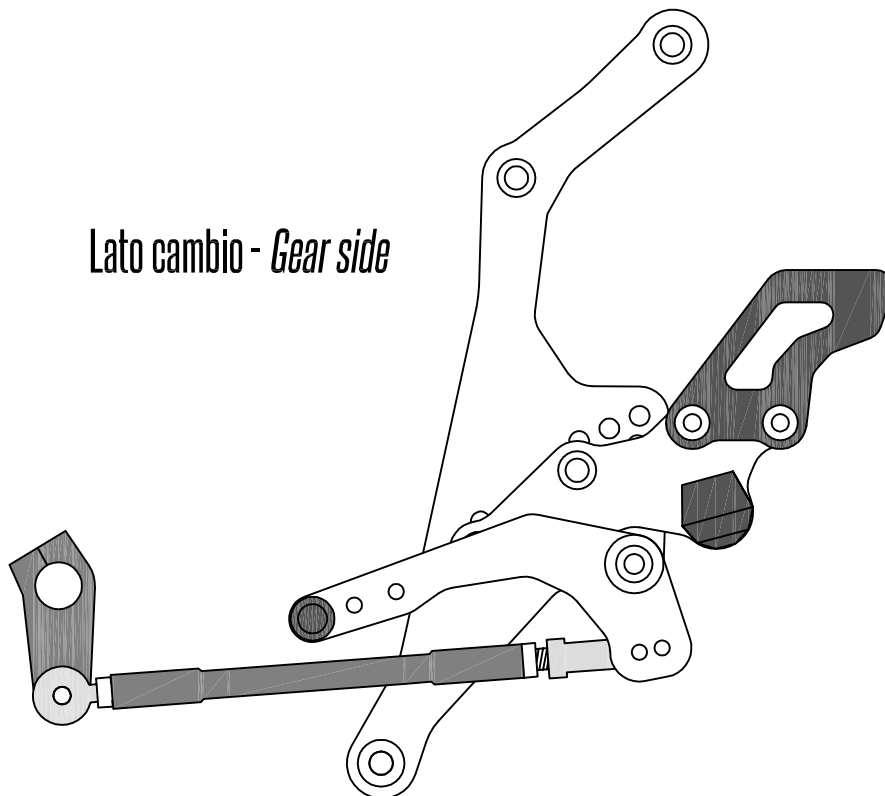

Lato cambio - *Gear side*

GeckoRacing

Ducati Monster 600, 620, 695, 720, 800, 900, 1000, S4

Bustina 1 - Bag 1 - (x2 con pedane passeggero | x2 with pillion pegs)
pedali poggiapiede - footrest pegs



x2 + x2 bm8x16

Bustina 2 - Bag 2
pedalini leve - levers pedals

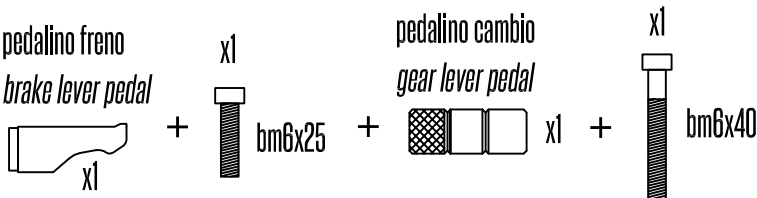

pedalino freno
brake lever pedal x1 + bm6x25 + pedalino cambio
gear lever pedal x1 + bm6x40

Bustina 3 - Bag 3
paratacchi - heel guards

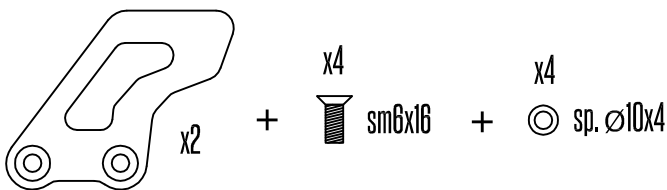

x2 + x4 sm6x16 + x4 sp. Ø10x4

Bustina 4 - Bag 4
telaio - frame

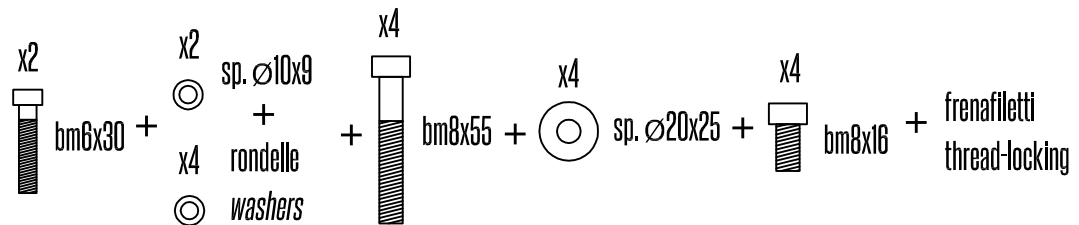

x2 bm6x30 + x2 sp. Ø10x9 + x4 rondelle washers + x4 bm8x55 + x4 sp. Ø20x25 + x4 bm8x16 + frenafilotti thread-locking

Bustina 5 - Bag 5
telaio - frame

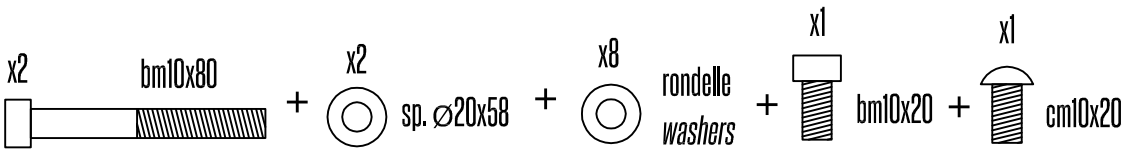

x2 bm10x80 + x2 sp. Ø20x58 + x8 rondelle washers + x1 bm10x20 + x1 cm10x20

Bustina 6 - Bag 6
cambio - gear

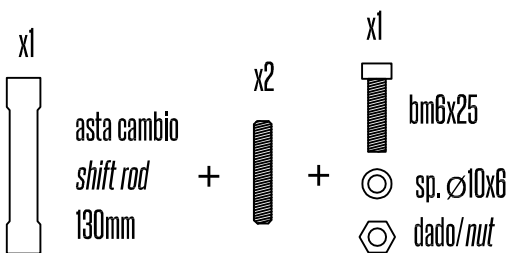

x1 asta cambio shift rod 130mm + x2 + x1 bm6x25 + sp. Ø10x6 dado/nut

Bustina 7 - Bag 7
solo con staffe passeggero - only with pillion pegs

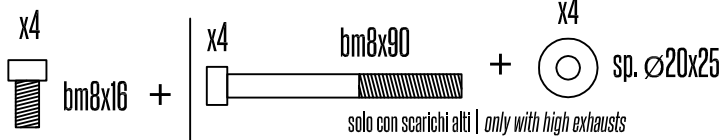

x4 bm8x16 + x4 bm8x90 + x4 sp. Ø20x25
solo con scarichi alti | only with high exhausts

Bustina 8 - Bag 8
paratacchi per pedane passeggero - heel guards on pillion pegs



x2 + x4 sm6x16 + x4 sp. Ø10x4

Idrostop
se ordinato - if ordered



x2 rondelle washers

GeckoRacing

Ducati Monster 600, 620, 695, 720, 800, 900, 1000, S4

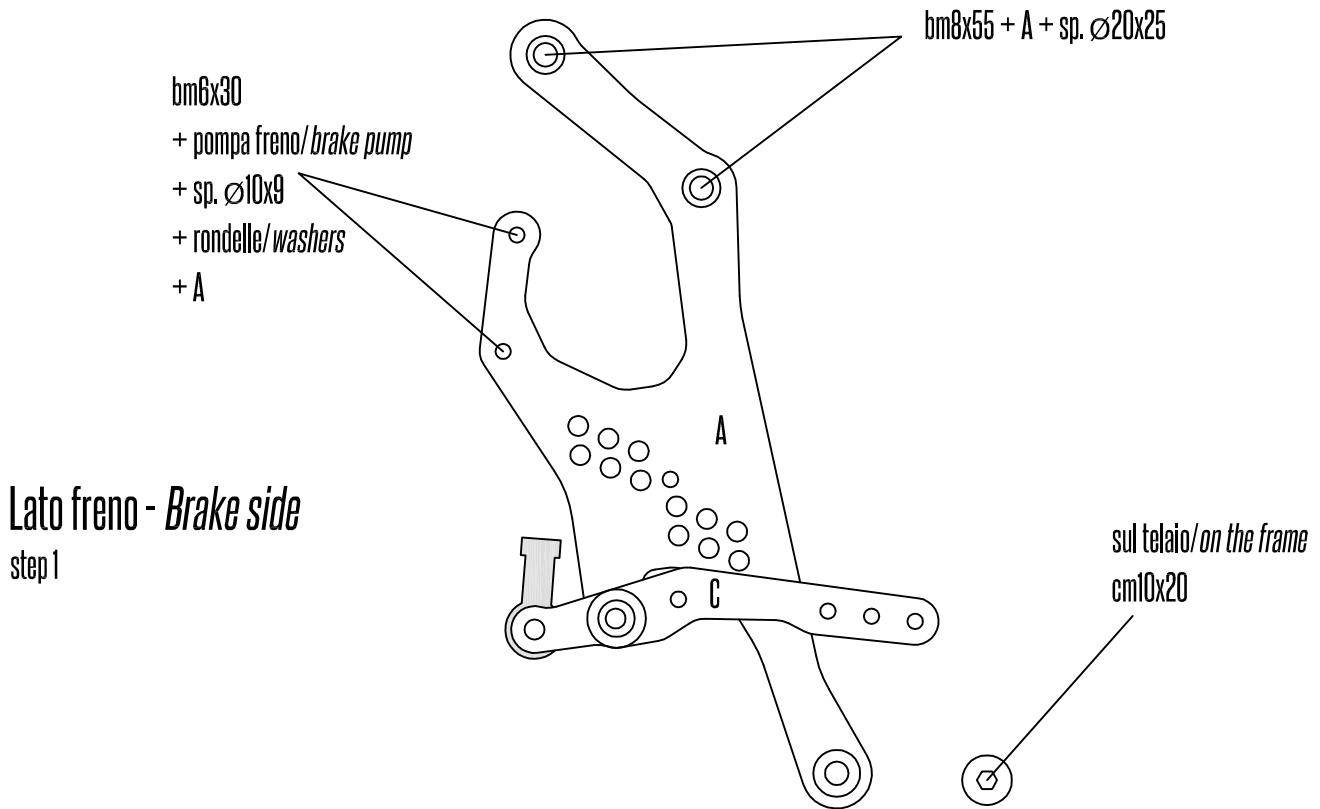

Lato freno - Brake side
step 2

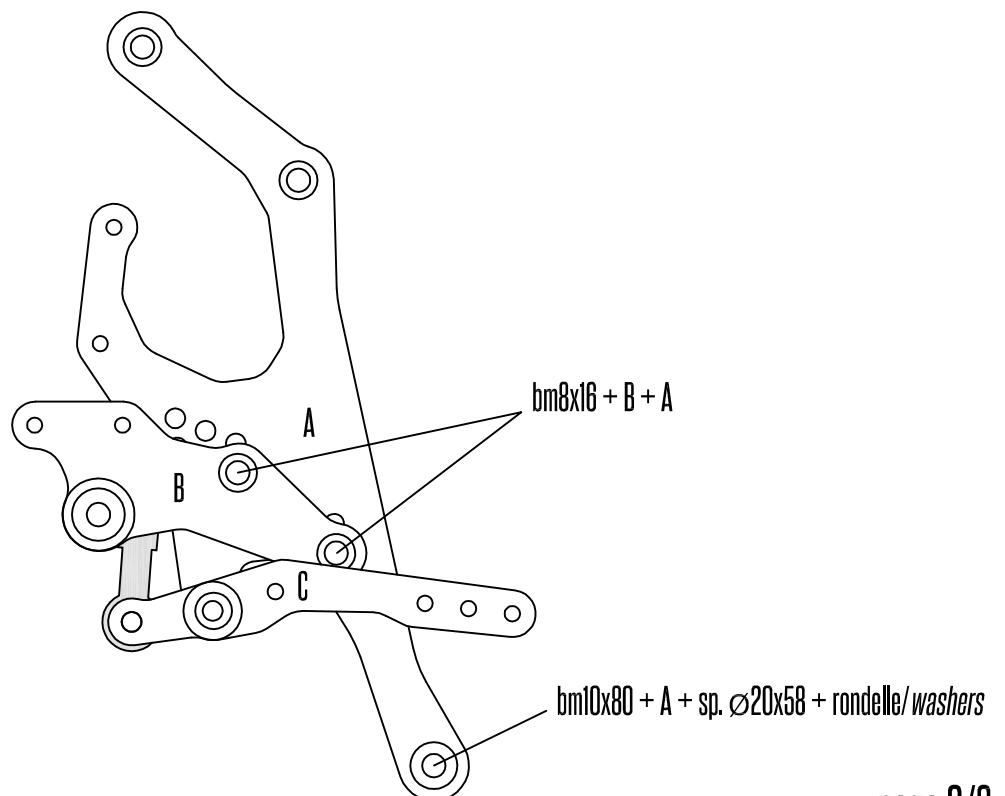

GeckoRacing

Ducati Monster 600, 620, 695, 720, 800, 900, 1000, S4

Lato freno - *Brake side*

step 3

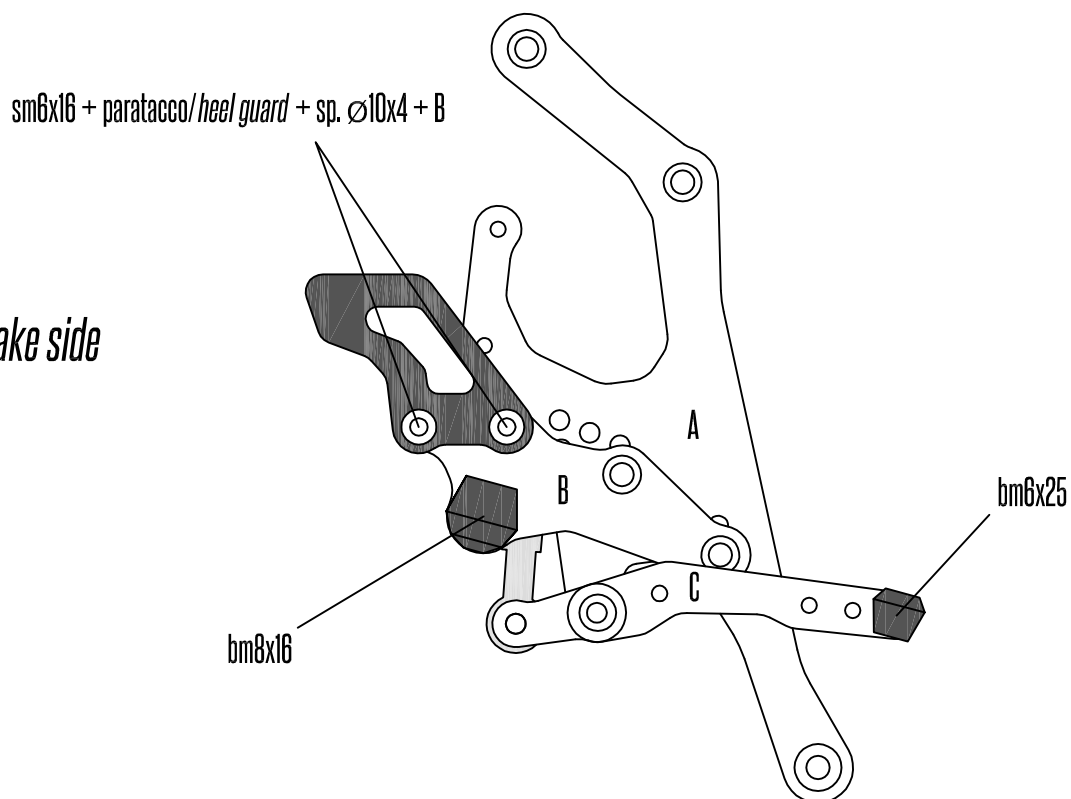

Lato cambio - *Gear side*

step 1

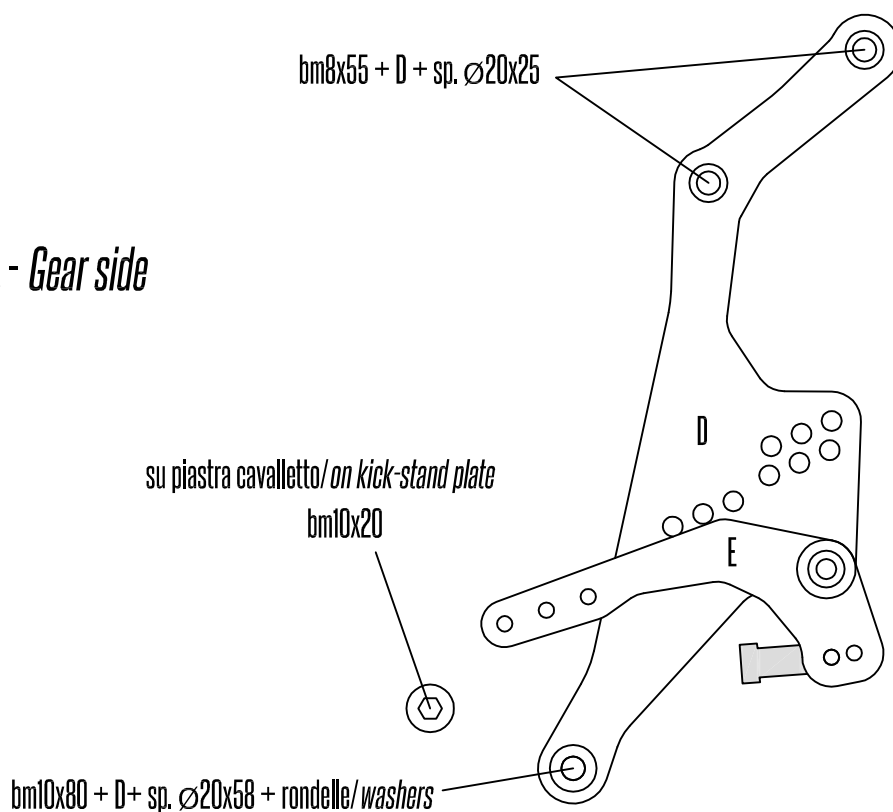

GeckoRacing

Ducati Monster 600, 620, 695, 720, 800, 900, 1000, S4

Lato cambio - Gear side

step 2

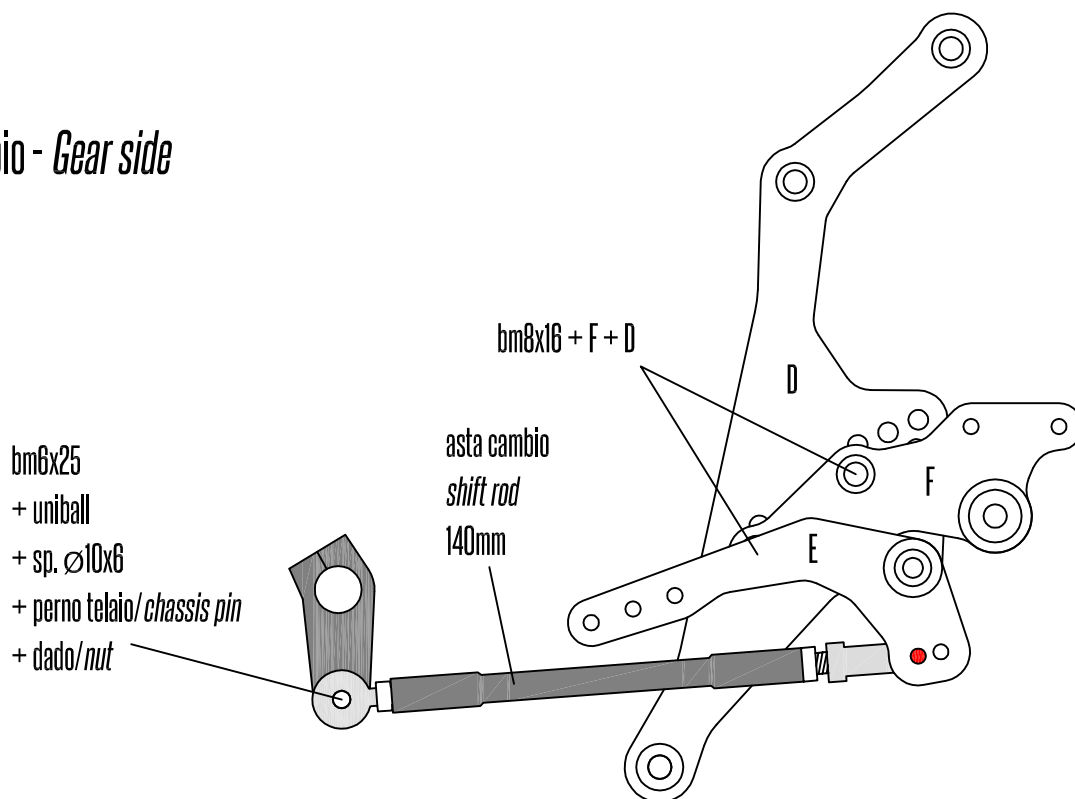

Lato cambio - Gear side

step 3

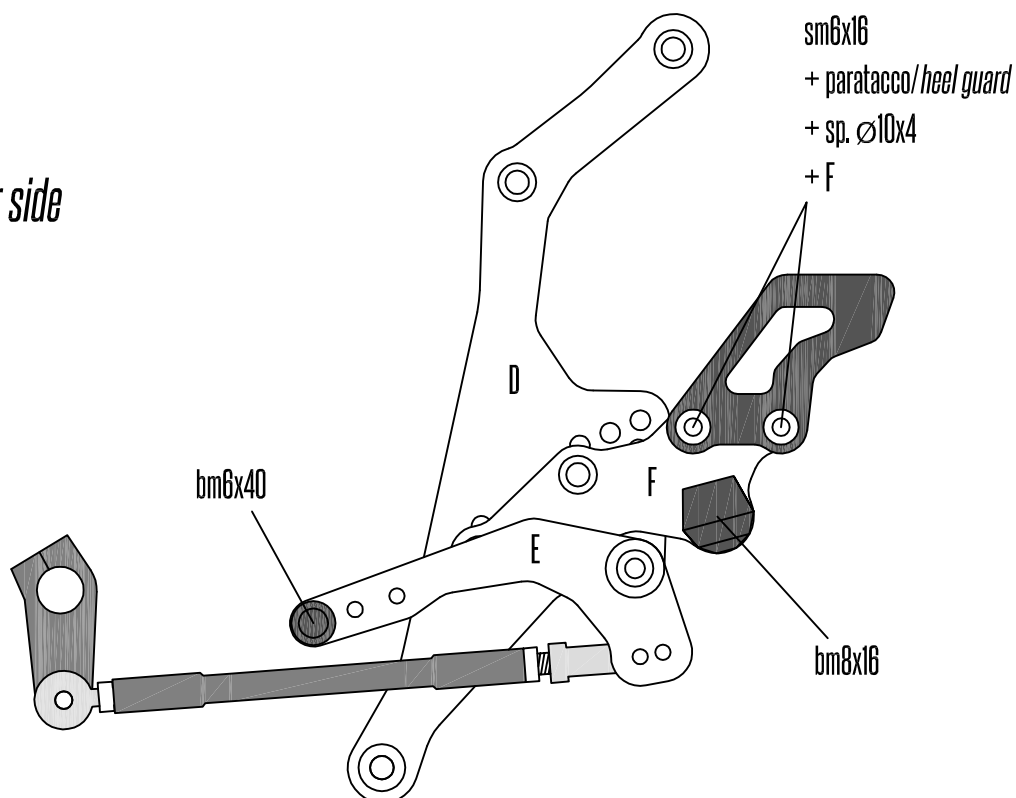

Ducati Monster 600, 620, 695, 720, 800, 900, 1000, S4

Cambio rovesciato - Reverse gear

bm6x25
+ uniball
+ sp. $\varnothing 10 \times 6$
+ perno telaio / chassis pin
+ dado / nut

asta cambio
shift rod
140mm

ruotare il perno verso l'alto
turn upside up the chassis pin

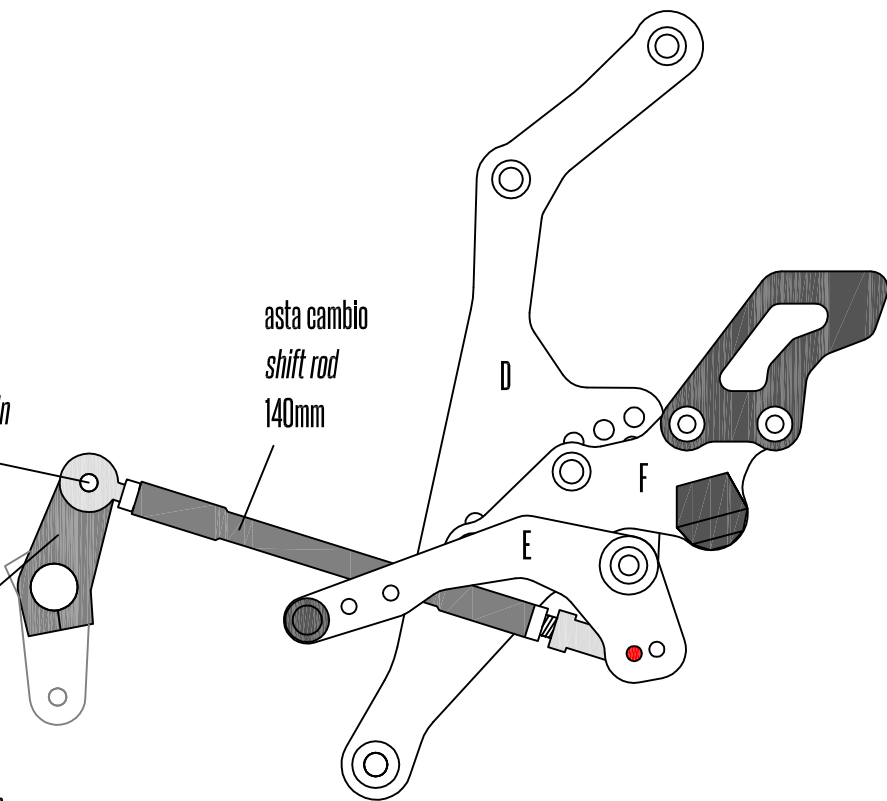

con scarichi bassi | with low exhausts

bm8x55 + G + A + sp. $\varnothing 20 \times 25$

con scarichi alti | with high exhausts

bm8x90 + G + sp. $\varnothing 20 \times 25$ + A + sp. $\varnothing 20 \times 25$

Staffe scarico - Exhausts brackets

se ordinate/if ordered

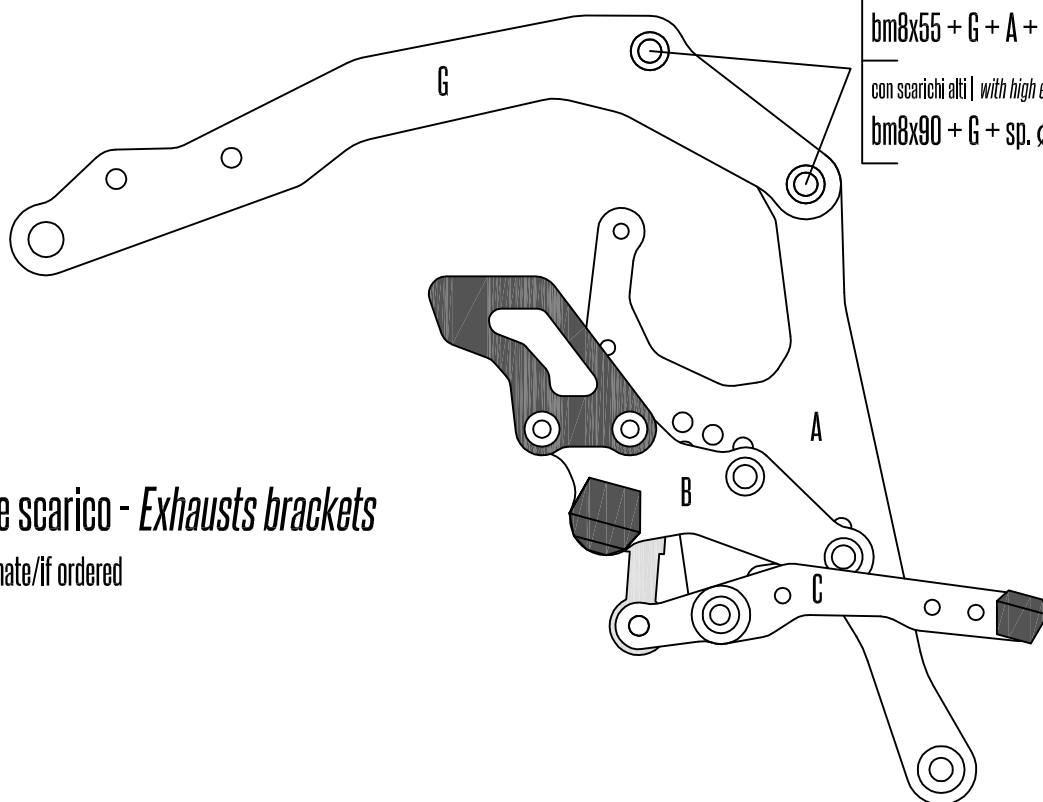

Ducati Monster 600, 620, 695, 720, 800, 900, 1000, S4

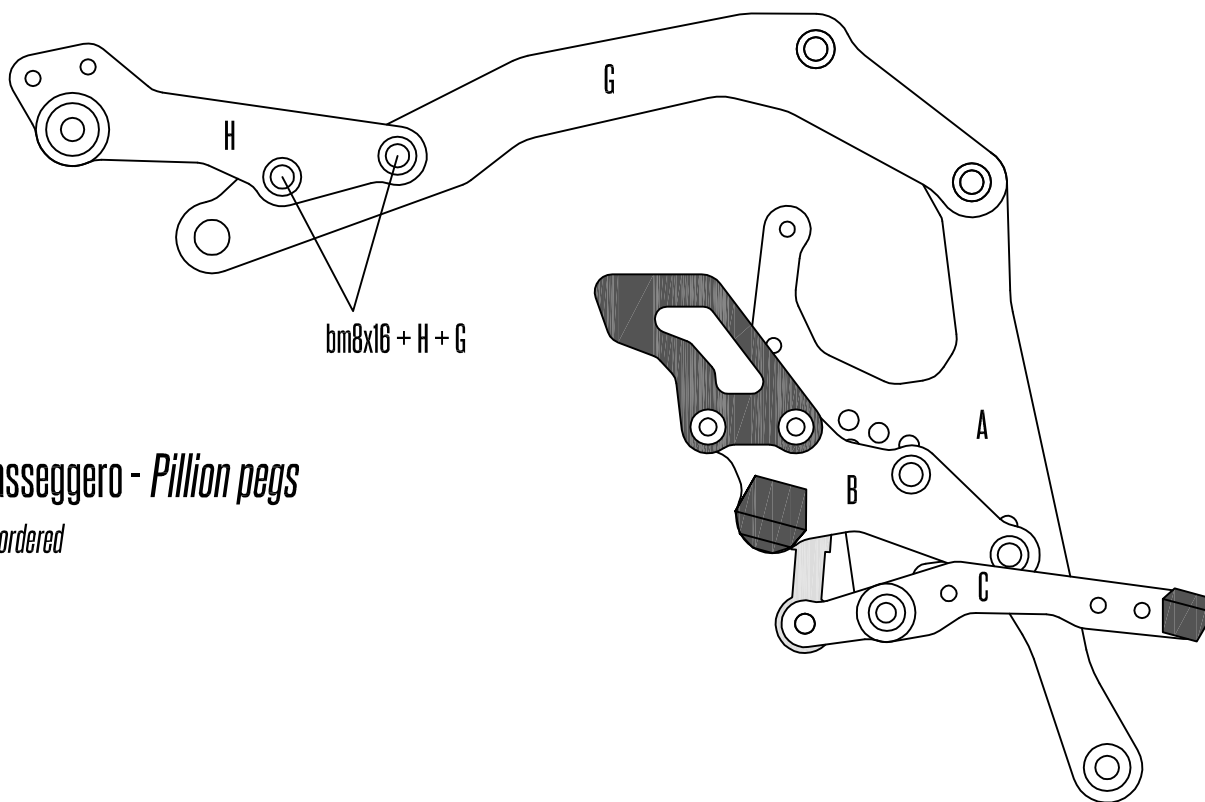

Pedane passeggero - Pillion pegs

se ordinate/ if ordered

step 1

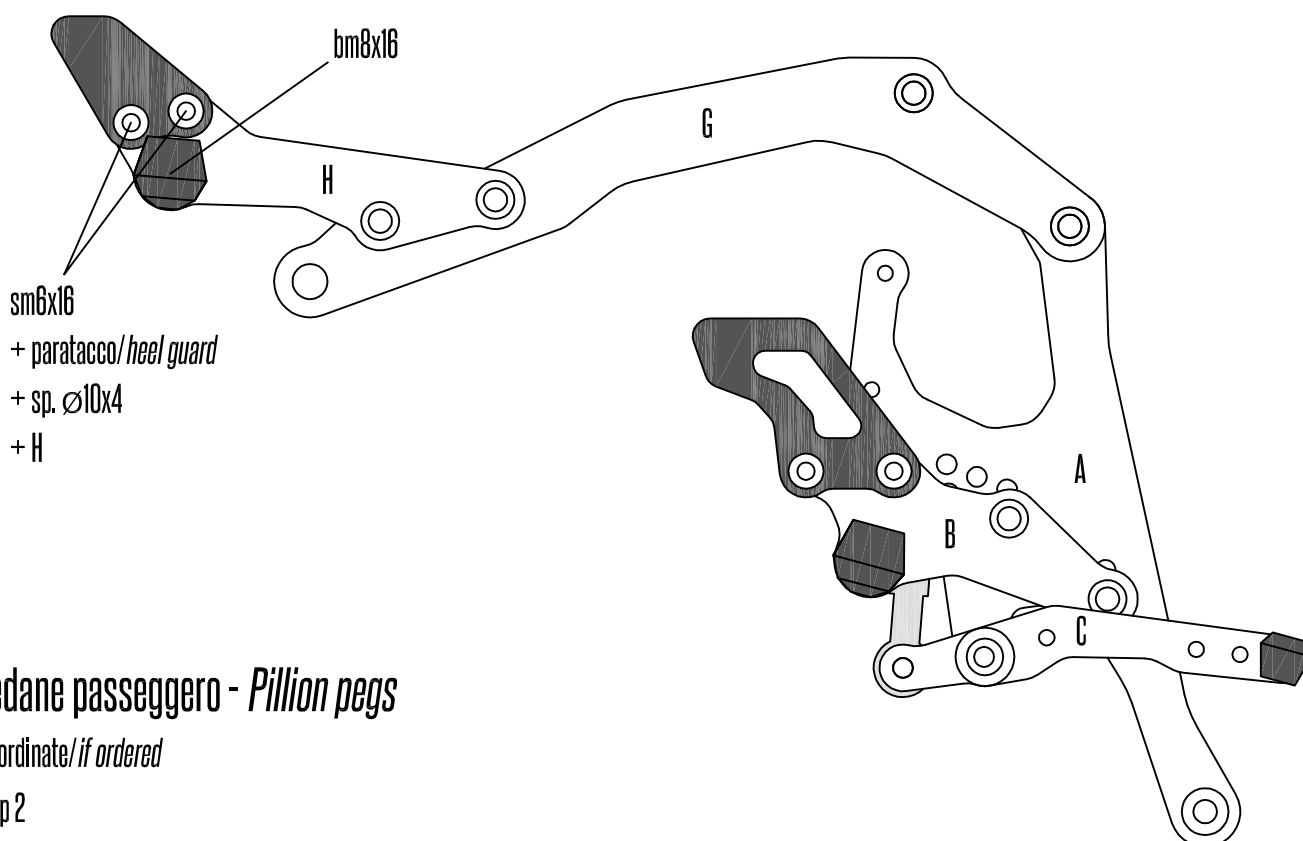

Pedane passeggero - Pillion pegs

se ordinate/ if ordered

step 2

Ducati Monster 600, 620, 695, 720, 800, 900, 1000, S4

Idrostop

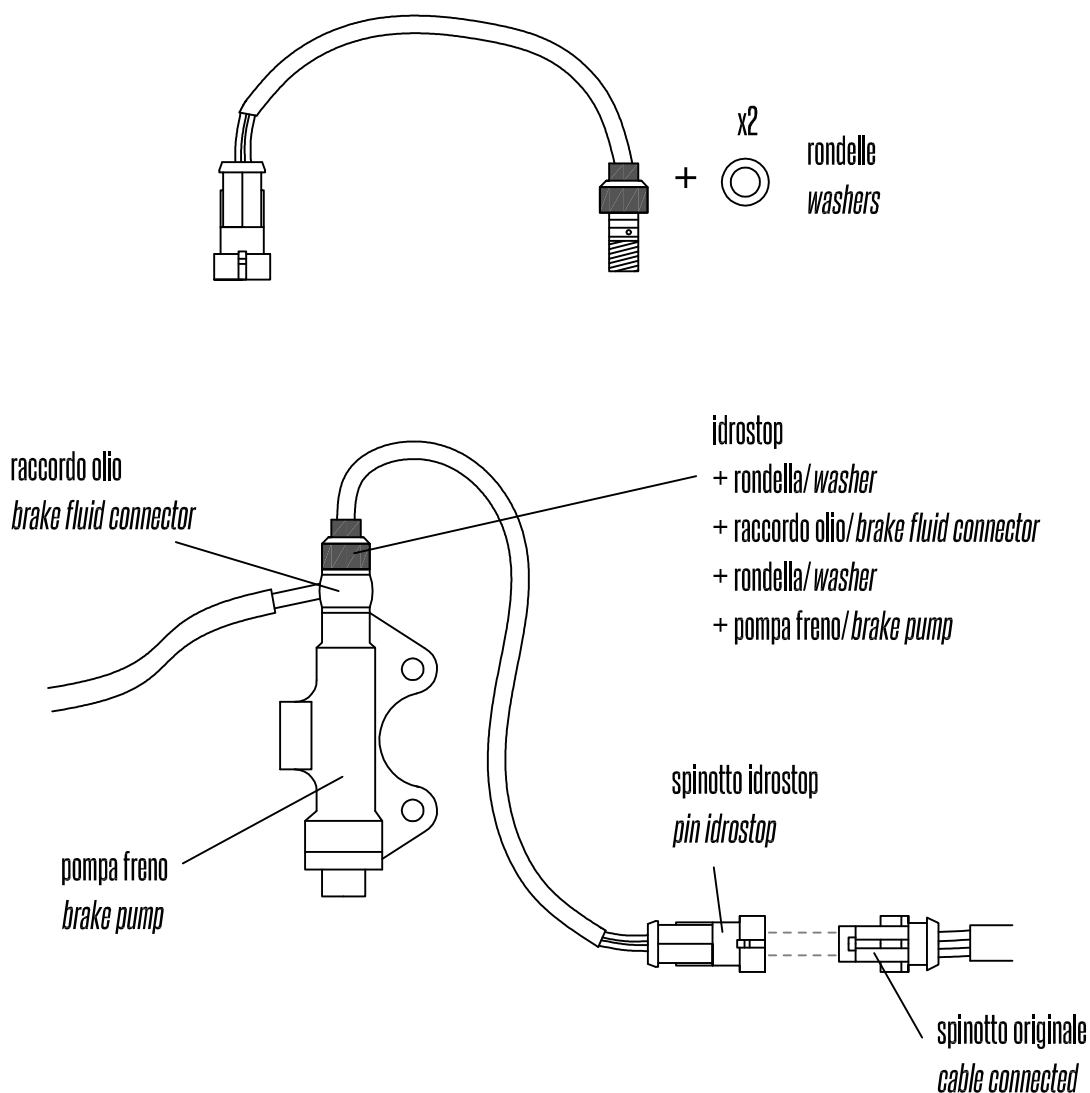

Su alcuni modelli di moto (es: MT-07 e Hornet >2007) lo spinotto originale è diverso da quello descritto nell'immagine.

Su altri modelli invece il cavo può risultare corto e non permette il collegamento con lo spinotto.

In questi due casi è necessario cablare i fili con l'idrostop per poterlo collegare, oppure usare altri fili come prolungha.

È consigliabile effettuare lo spurgo al termine del montaggio dell'idrostop, ma non è necessario se l'operazione viene effettuata correttamente.

For some models (ex: MT-07, Hornet >2007) the cable connected is different. In these case you need to cable the original one to connect on idrostop.

It's recommended to flush the brake fluid at the end of the idrostop mounting, but it's not necessary if the operation is successful.