

Ducati Streetfighter 848, 1098, 1100

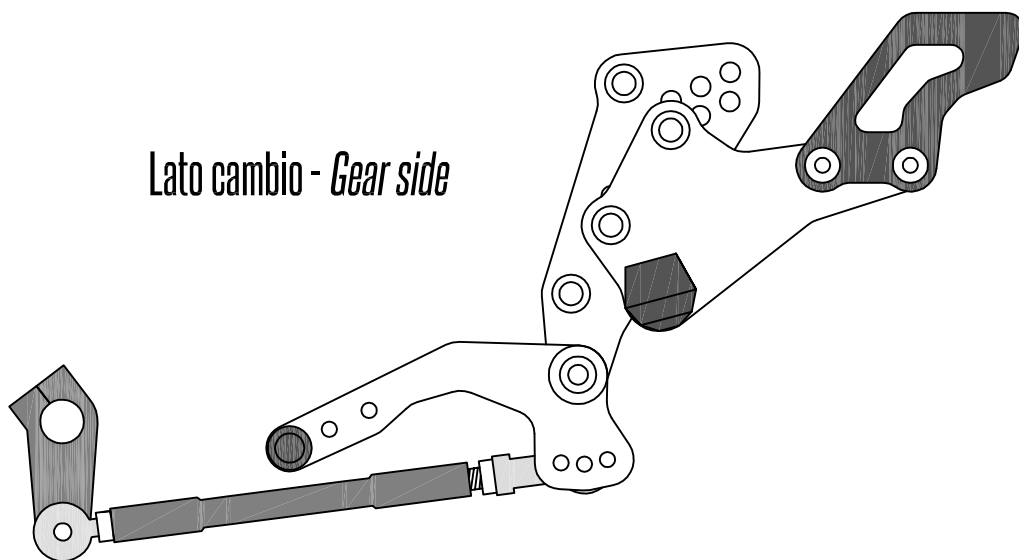
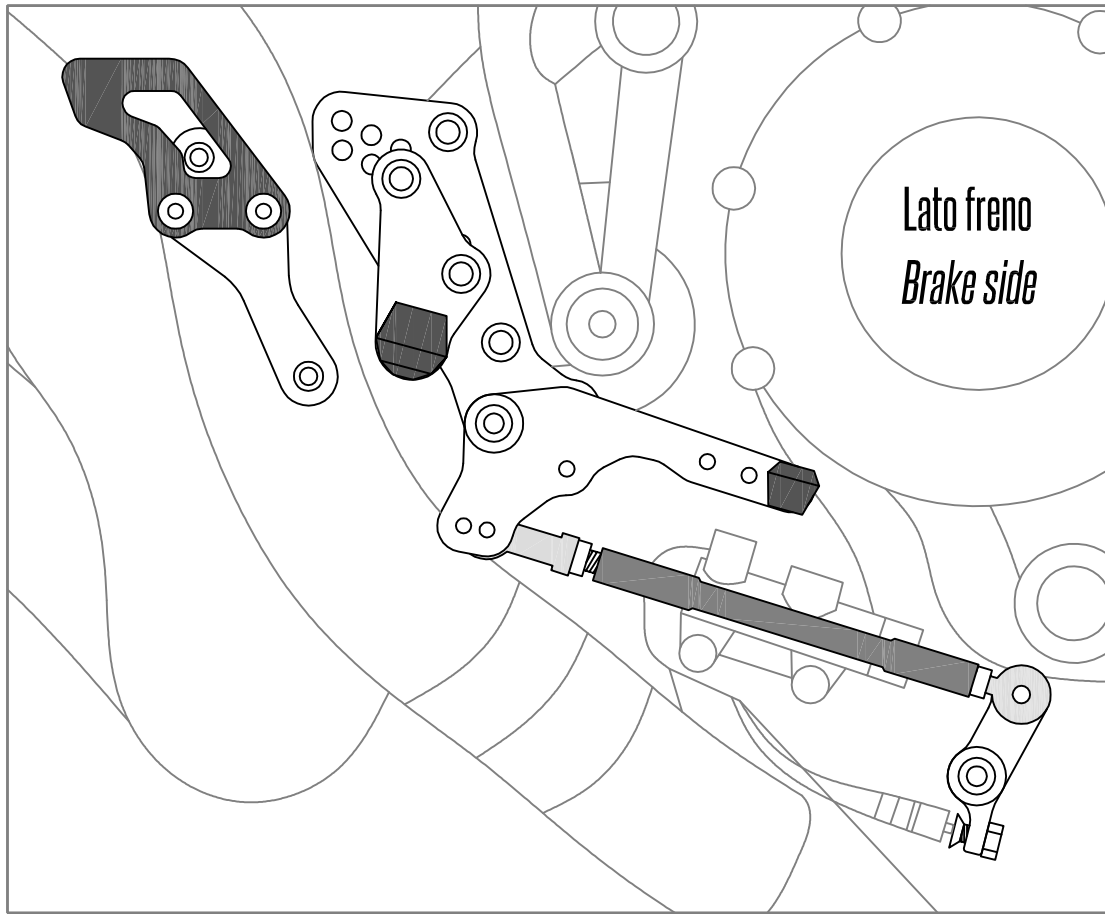

GeckoRacing

Ducati Streetfighter 848, 1098, 1100

Bustina 1 - Bag 1

pedali poggiapiede - *footrest pegs*

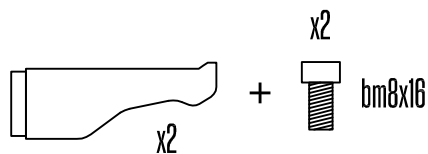

Bustina 2 - Bag 2

pedalini leve - *levers pedals*

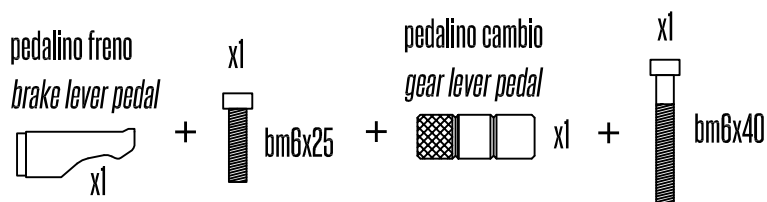

Bustina 3 - Bag 3

paratacchi - *heel guards*

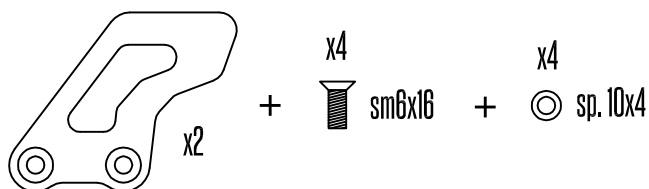

Bustina 4 - Bag 4

telaio - *frame*

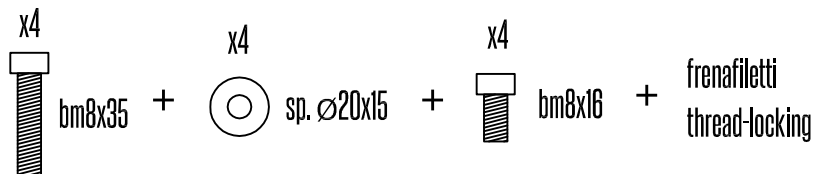

Bustina 5 - Bag 5

paratacco/paracalore - *heel guard/heat shield*

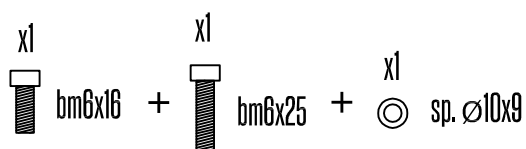

Bustina 6 - Bag 6

asta freno - *brake shift rod*

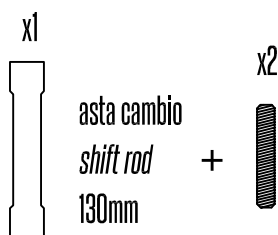

Bustina 7 - Bag 7

asta cambio - *gear shift rod*

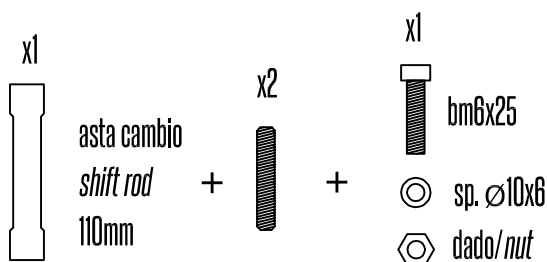

Ducati Streetfighter 848, 1098, 1100

Lato freno
Brake side
step 1

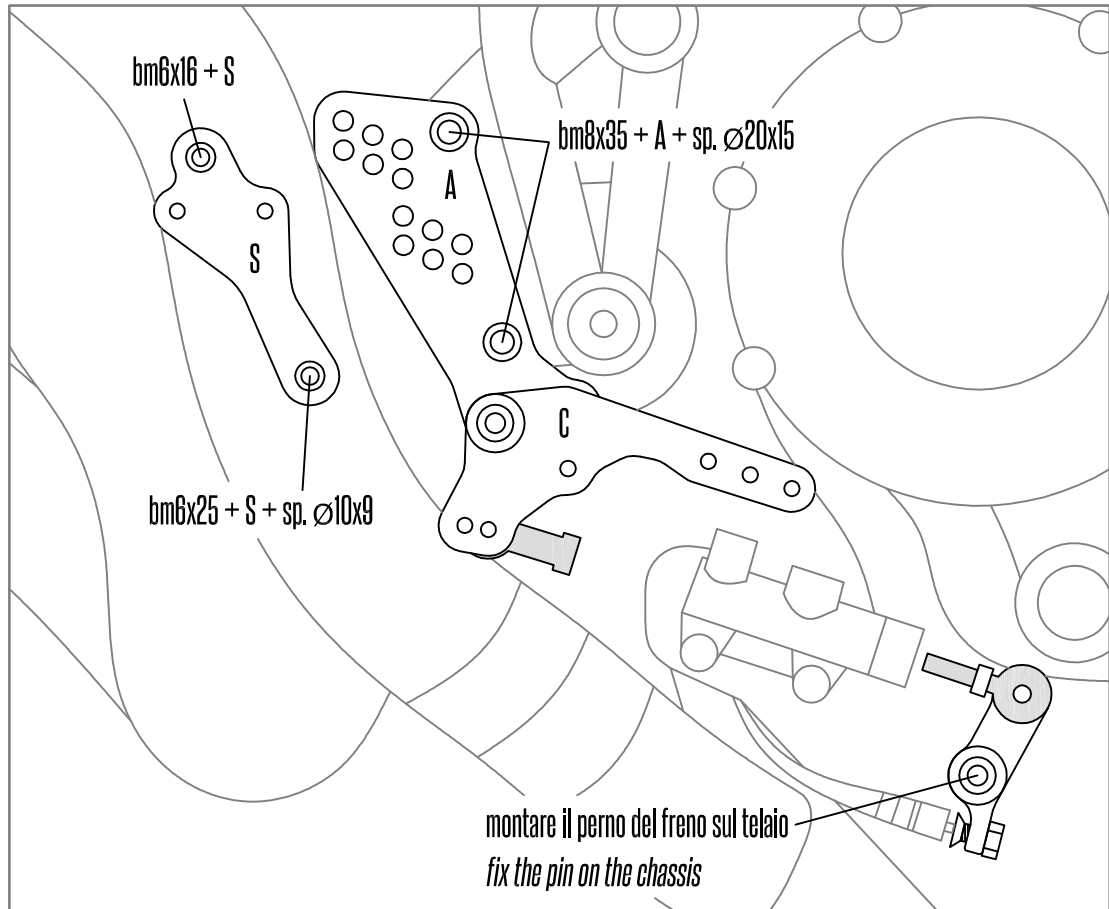

Lato freno
Brake side
step 2

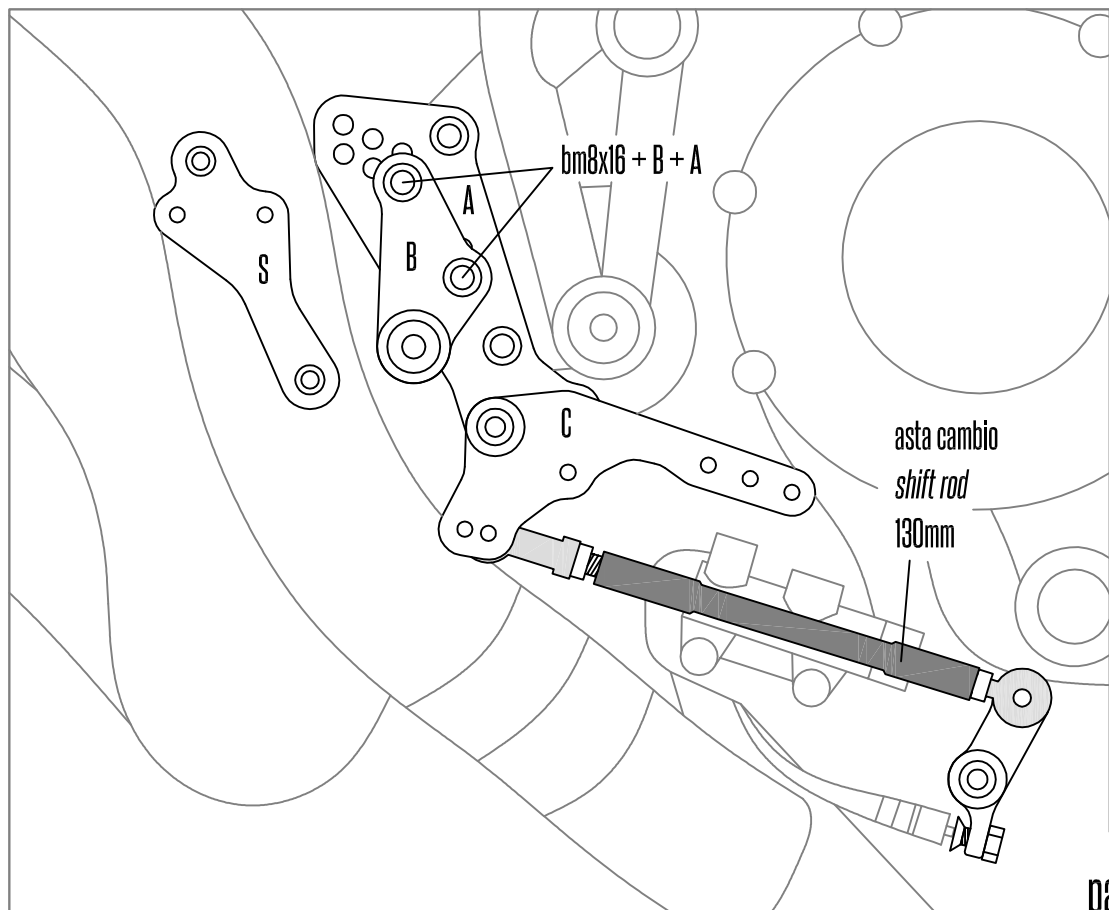

Ducati Streetfighter 848, 1098, 1100

Lato freno
Brake side
step 3

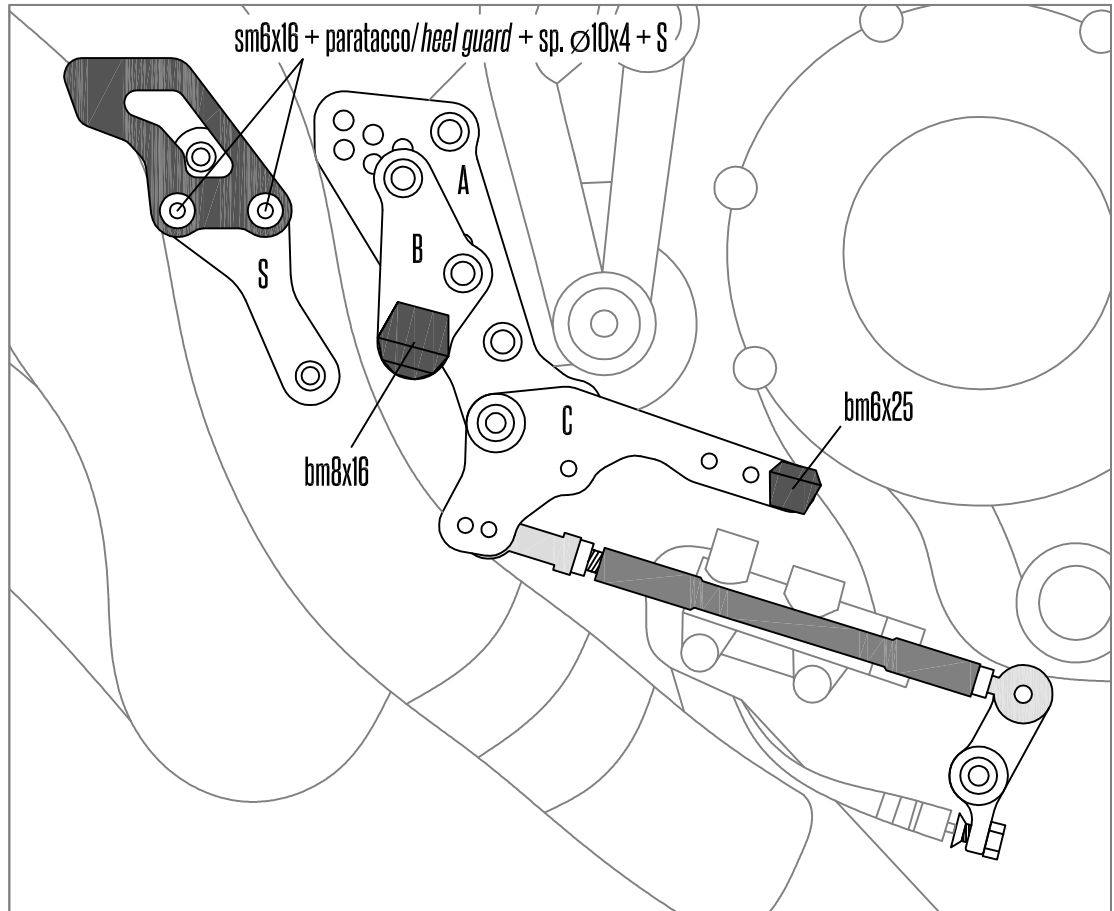

Lato cambio - *Gear side*

step 1

ruotare leggermente il perno in senso antiorario
turn slightly counterclockwise the chassis pin

bm6x25

+ uniball

+ sp. $\varnothing 10 \times 6$

+ perno telaio/ *chassis pin*

+ dado/ *nut*

bm8x35 + D + sp. $\varnothing 20 \times 15$

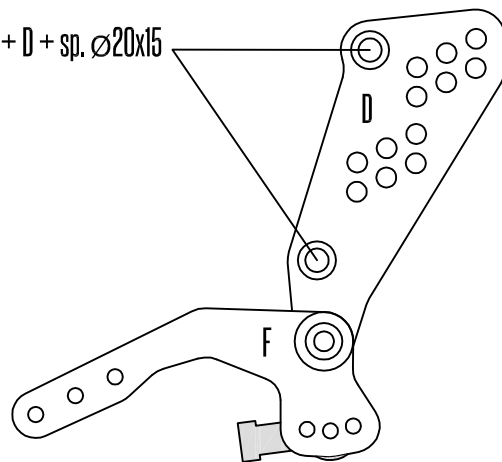

Ducati Streetfighter 848, 1098, 1100

Lato cambio - *Gear side*

step 2

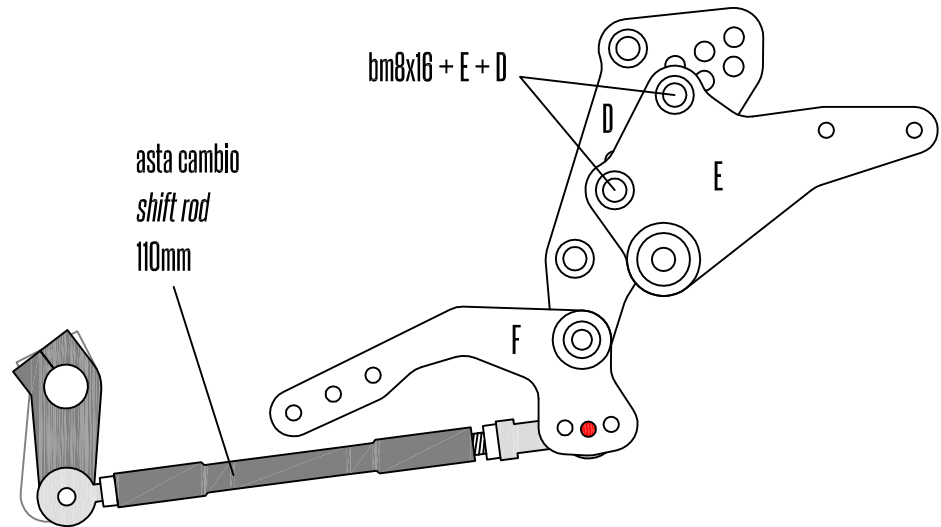

Lato cambio - *Gear side*

step 3

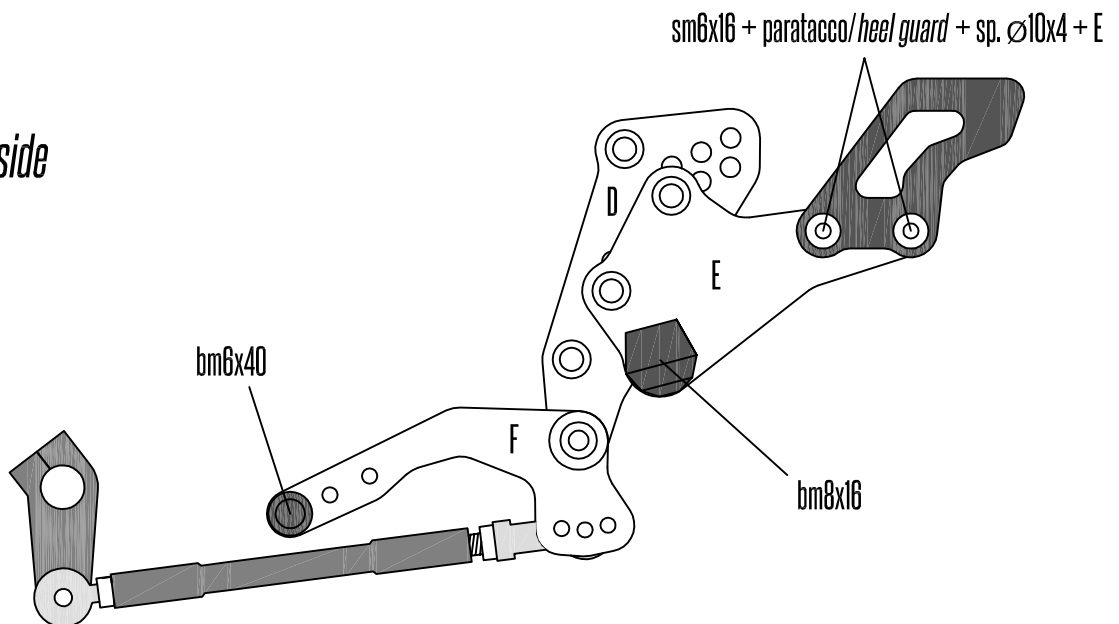

Cambio rovesciato - *Reverse gear*

ruotare il perno verso l'alto
turn upside up the chassis pin

