

# GeckoRacing

## Yamaha Mt-07

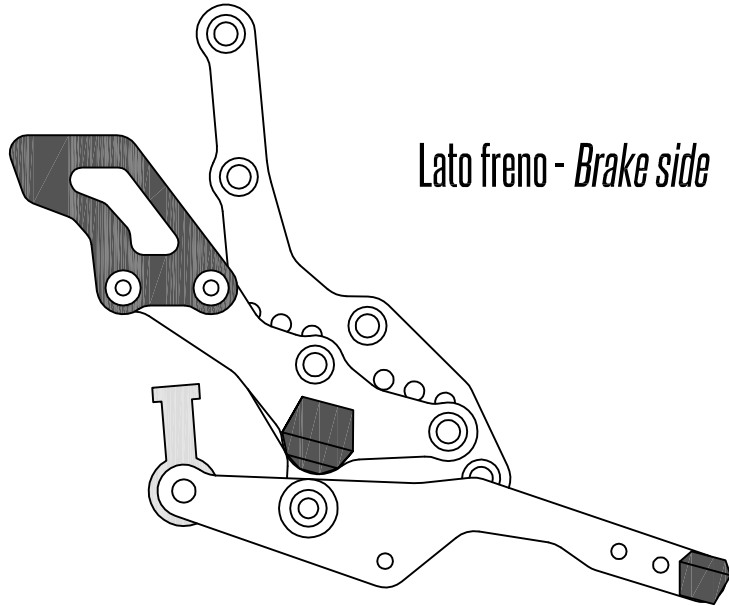

Lato freno - *Brake side*

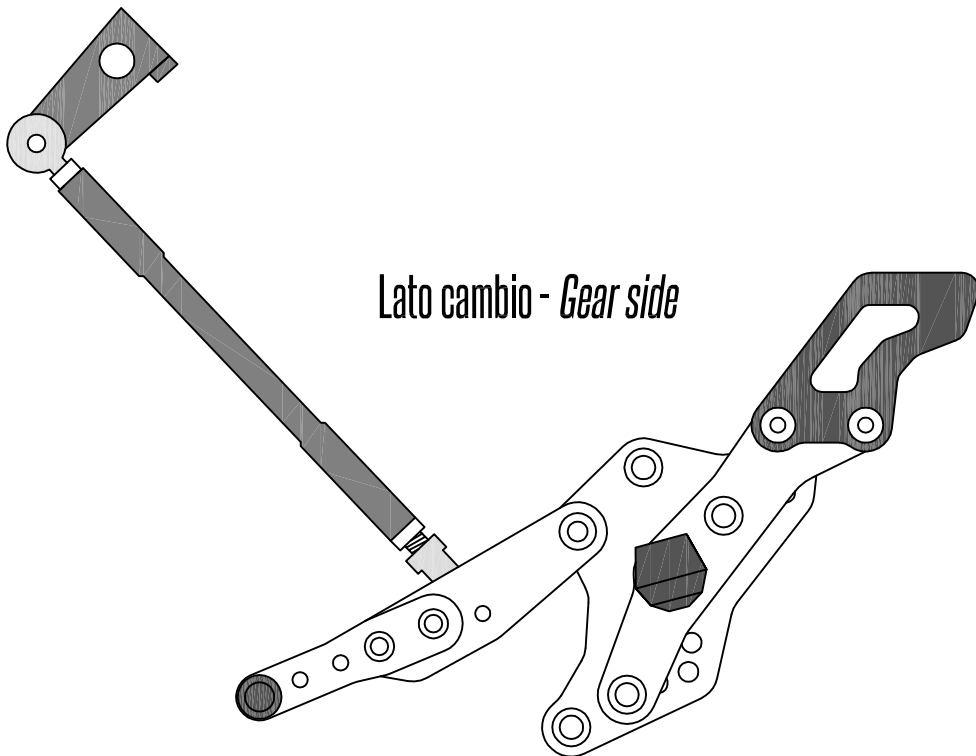

Lato cambio - *Gear side*

# GeckoRacing

## Yamaha Mt-07

### Bustina 1 - Bag 1

pedali poggiapiede - *footrest pegs*

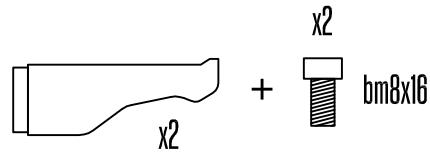

### Bustina 2 - Bag 2

pedalini leve - *levers pedals*

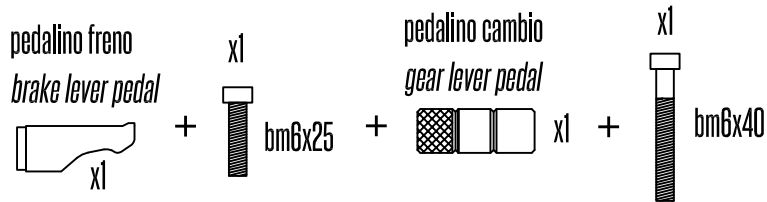

### Bustina 3 - Bag 3

paratacchi - *heel guards*

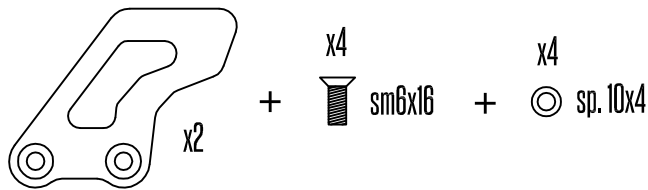

### Bustina 4 - Bag 4

telaio - *frame*

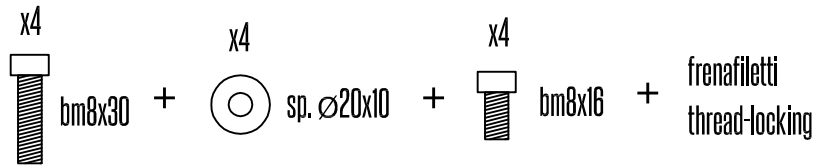

### Bustina 5 - Bag 5

pompa olio e cambio - *oil pump and gear*

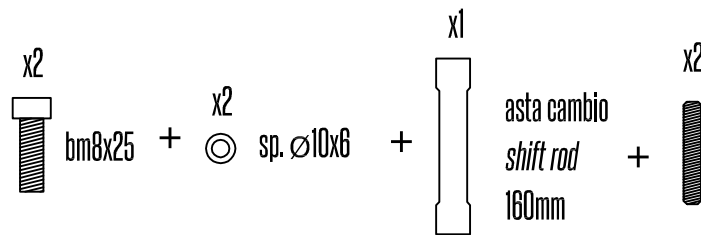

### Idrostop

se ordinato - *if ordered*

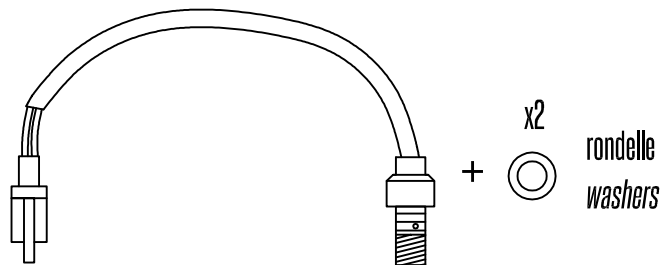

# GeckoRacing

## Yamaha Mt-07

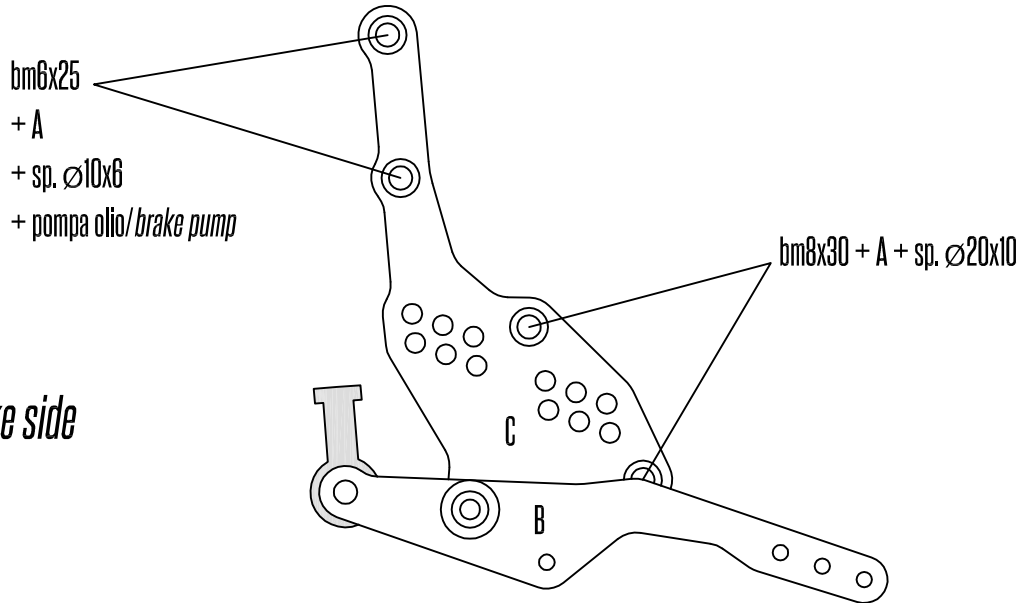

### Lato freno - *Brake side* step 2

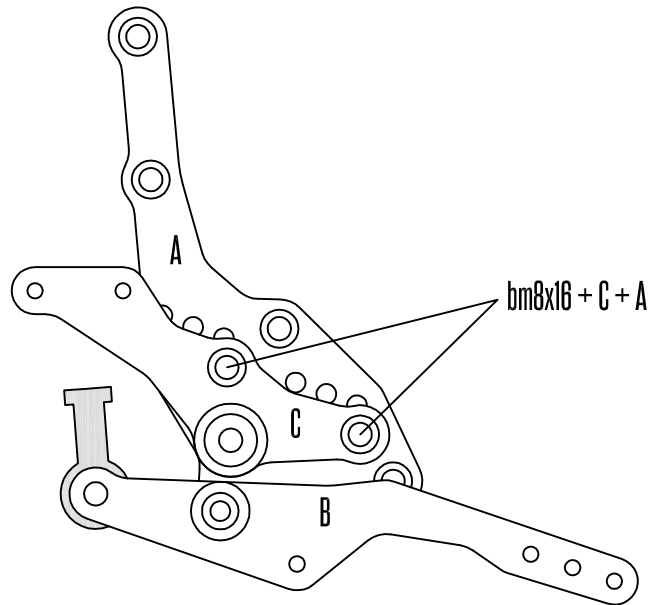

### Lato freno - *Brake side* step 3

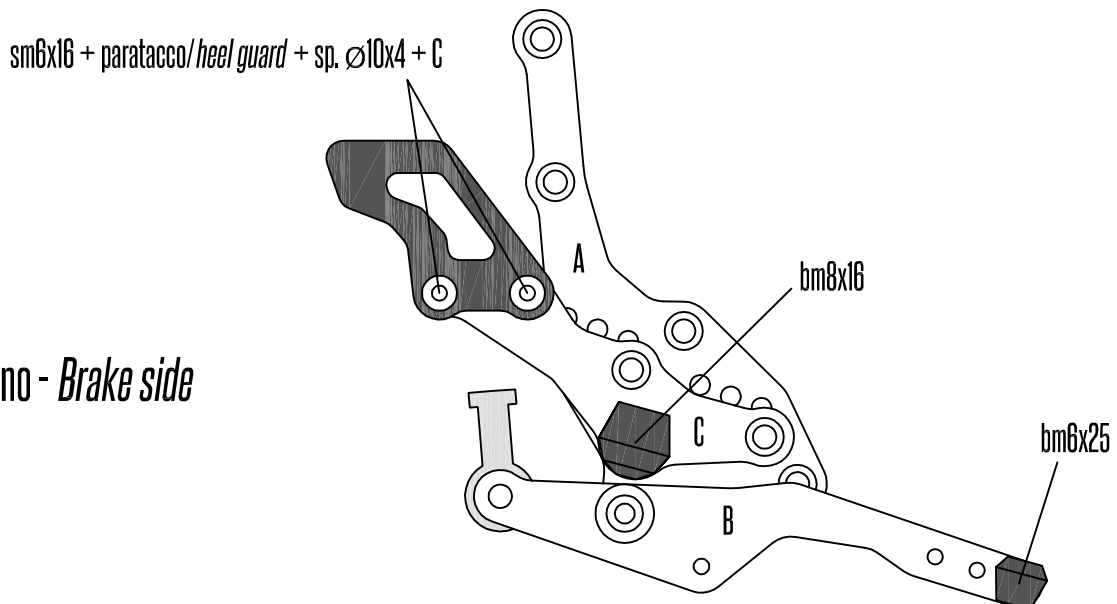

# GeckoRacing

## Yamaha Mt-07

Lato cambio - *Gear side*  
step 1

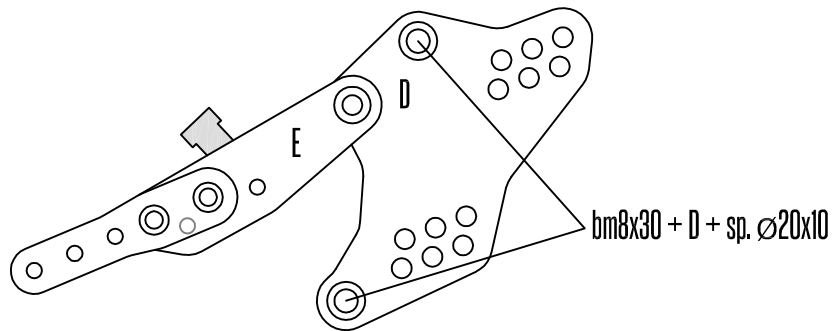

Lato cambio - *Gear side*  
step 2

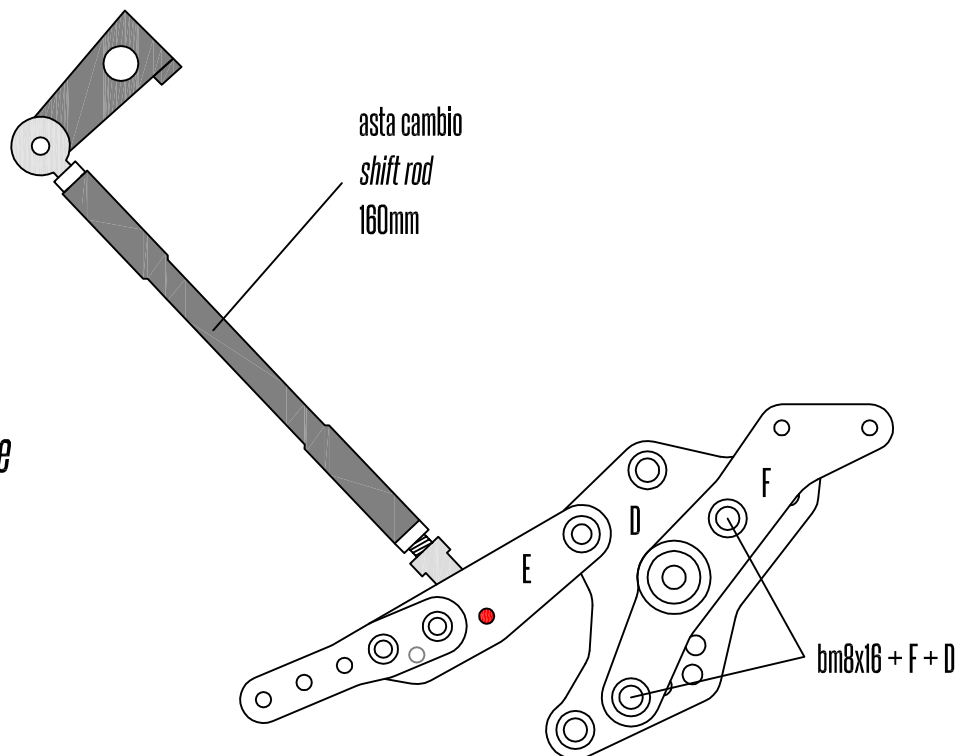

# GeckoRacing

## Yamaha Mt-07

### Lato cambio - Gear side

step 3

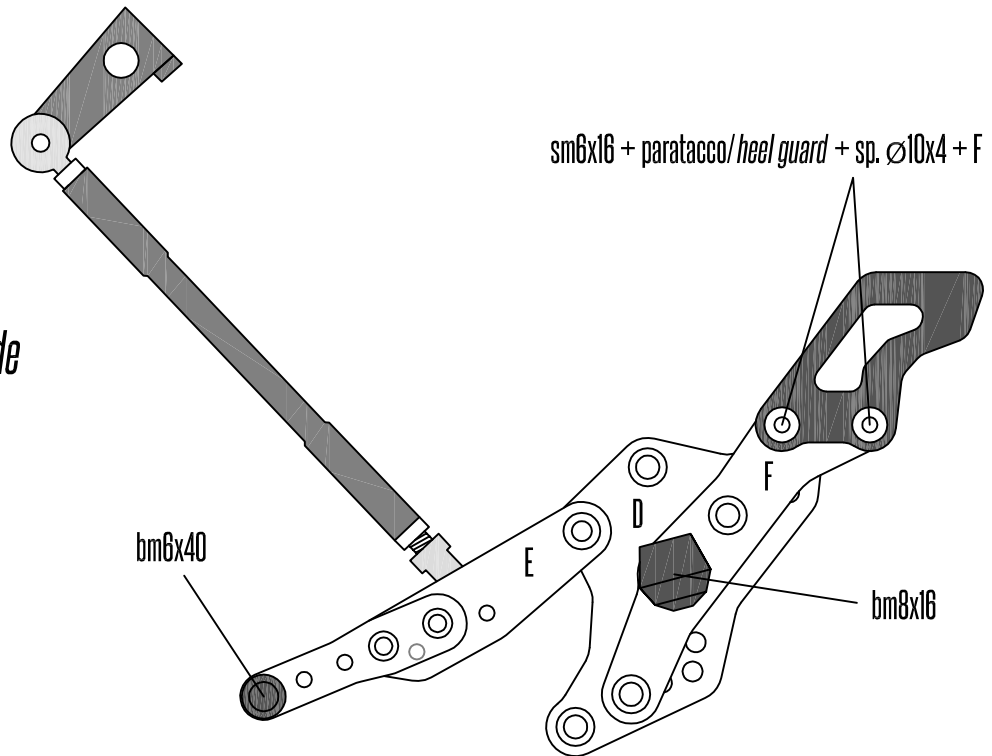

ruotare il perno verso destra  
turn to the right up the chassis pin

asta cambio  
shift rod  
160mm

### Cambio rovesciato - Reverse gear

spostare la testa a snodo nel foro più a sinistra  
move the uniball in the hole on the left

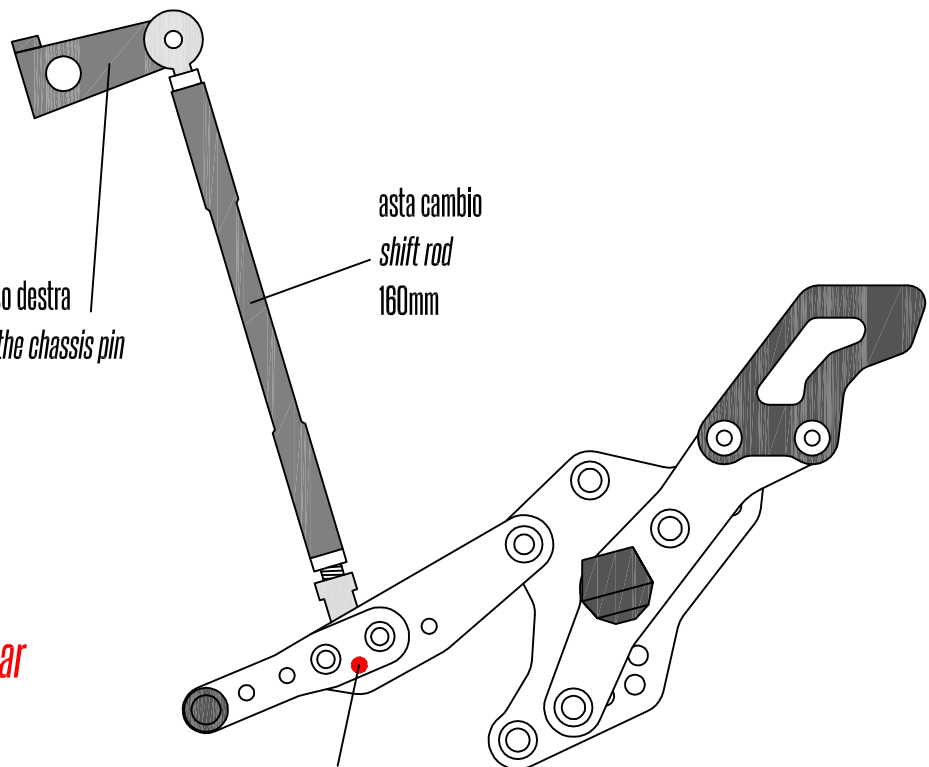

# GeckoRacing

## Yamaha Mt-07

### Idrostop

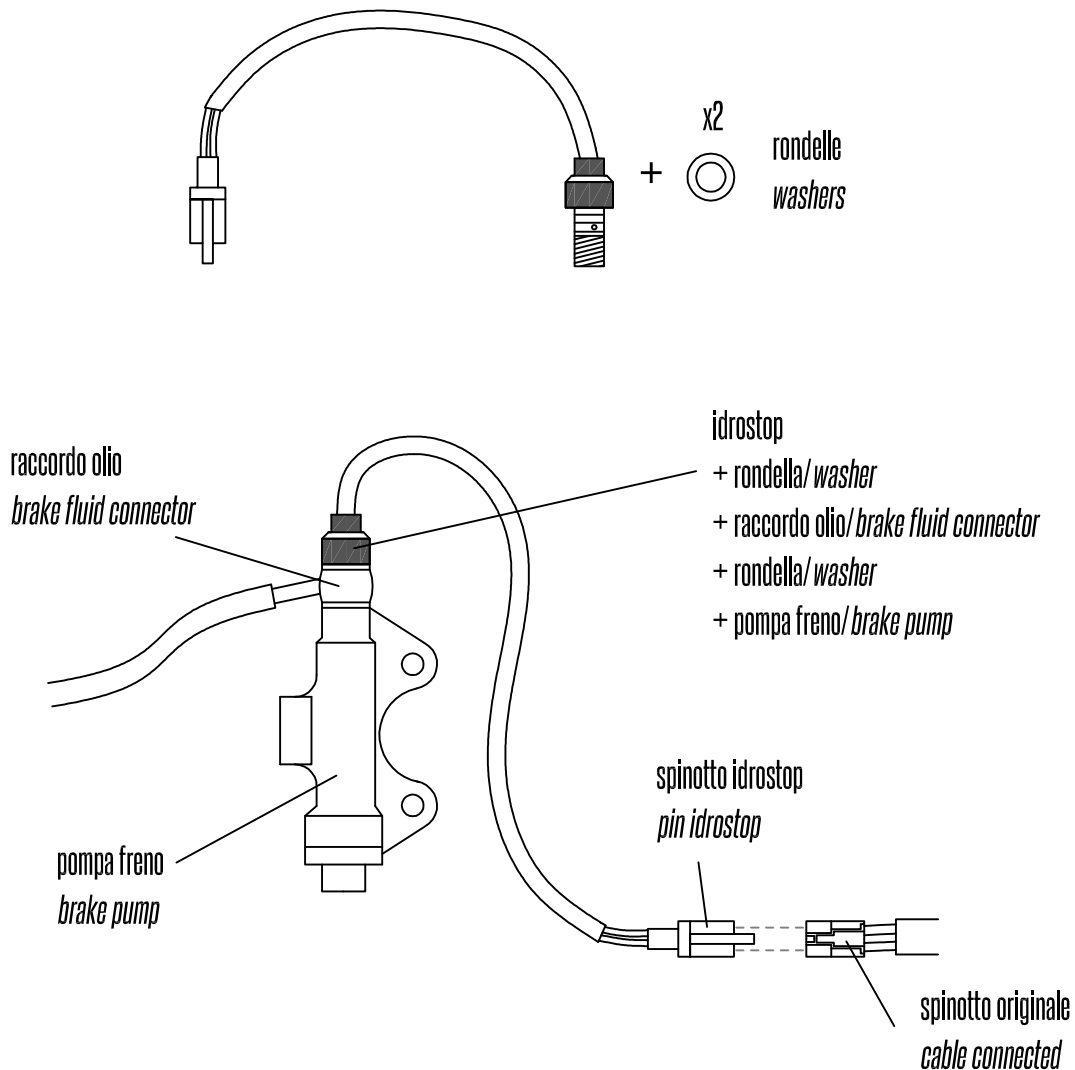

Su alcuni modelli di moto (es: Mt-07 e Hornet >2007) lo spinotto originale è diverso da quello descritto nell'immagine.

Su altri modelli invece il cavo può risultare corto e non permette il collegamento con lo spinotto.

In questi due casi è necessario cablare i fili con l'idrostop per poterlo collegare, oppure usare altri fili come prolungha.

È consigliabile effettuare lo spurgo al termine del montaggio dell'idrostop, ma non è necessario se l'operazione viene effettuata correttamente.

*For some models (ex: MT-07, Hornet >2007) the cable connected is different. In these case you need to cable the original one to connect on idrostop.*

*It's recommended to flush the brake fluid at the end of the idrostop mounting, but it's not necessary if the operation is successful.*